

**APPENDIX C**  
**Accident Analysis/Collision**  
**Diagrams**



### Bronx River Greenway

#### Summary of Existing Highway Section Accident Rate

( Roadways where the bikeway alignment either run across, along or adjacent to)

	Accident #	All Types	WET ROAD	LEFT TURN	REAR END	OVERTAKING	RIGHT ANGLE	RIGHT TURN	HEAD ON	SIDESWIPE
E Tremont Ave + Boston Rd	28 Accident Rate (ACC/MEV) State Average (ACC/MEV)	28 1.02 0.60	4 0.15 0.08	2 0.07 0.09	9 0.33 0.13	5 0.18 0.03	0 0.00 0.08	0 0.00 0.01	0 0.00 0.00	1 0.04 0.00
E Tremont Ave + Devoe Ave + E 177th St.	59 Accident Rate (ACC/MEV) State Average (ACC/MEV)	59 1.87 0.60	12 0.38 0.08	6 0.19 0.09	21 0.67 0.13	19 0.60 0.03	2 0.06 0.08	3 0.10 0.01	0 0.00 0.00	1 0.03 0.00
E 177th St. + Devoe Ave	43 Accident Rate (ACC/MEV) State Average (ACC/MEV)	43 1.18 0.35	5 0.14 0.05	0 0.00 0.04	19 0.52 0.08	20 0.55 0.01	0 0.00 0.04	0 0.00 0.01	0 0.00 0.00	1 0.03 0.00

**Bronx River Greenway**

**Summary of Existing Highway Section Accident Rate (2)**

(Roadways where the bikeway alignment either run across, along or adjacent to)

	All Types	WET ROAD	LEFT TURN	REAR END	OVERTAKING	RIGHT ANGLE	RIGHT TURN	HEAD ON	SIDESWIPE	MEV *
Westchester Ave + Close Ave (5 Legs)	Accident #	0	3	2	2	3	2	0	1	
	Accident Rate (ACC/MEV)	0.00	0.08	0.05	0.05	0.08	0.05	0.00	0.03	40
	State Average (ACC/MEV)	0.08	0.09	0.13	0.03	0.08	0.01	0.00	0.00	
Boone Ave + Rreeman St (4 Legs)	Accident #	1	0	1	0	0	1	0	0	
	Accident Rate (ACC/MEV)	0.03	0.00	0.03	0.00	0.00	0.03	0.00	0.00	30
	State Average (ACC/MEV)	0.08	0.09	0.13	0.03	0.08	0.01	0.00	0.00	
Boone Ave + Westchester Ave (4 Legs)	Accident #	1	1	1	3	3	0	1	0	
	Accident Rate (ACC/MEV)	0.03	0.03	0.03	0.10	0.10	0.00	0.03	0.00	30
	State Average (ACC/MEV)	0.08	0.09	0.13	0.03	0.08	0.01	0.00	0.00	
Westchester Ave + Home St (3 Legs)	Accident #	1	0	0	1	0	1	0	0	
	Accident Rate (ACC/MEV)	0.04	0.00	0.00	0.04	0.00	0.04	0.00	0.00	25
	State Average (ACC/MEV)	0.05	0.04	0.08	0.01	0.04	0.01	0.00	0.00	
Westchester Ave + Edgewater Rd (3 Legs)	Accident #	0	0	2	1	0	1	0	0	
	Accident Rate (ACC/MEV)	0.00	0.00	0.08	0.04	0.00	0.04	0.00	0.00	25
	State Average (ACC/MEV)	0.05	0.04	0.08	0.01	0.04	0.01	0.00	0.00	
Westchester Ave + I-895 Ramp (3 Legs)	Accident #	2	1	0	0	1	0	0	0	
	Accident Rate (ACC/MEV)	0.08	0.04	0.00	0.00	0.04	0.00	0.00	0.00	25
	State Average (ACC/MEV)	0.05	0.04	0.08	0.01	0.04	0.01	0.00	0.00	

\* MEV is estimated based on data of E. Tremont Ave intersections

# ACCIDENT SUMMARY SHEET

ROUTE: *Bronx River Greenway*

LOCATION:

MUNICIPALITY: *BRONX*

COUNTY: *BRONX*

TIME PERIOD COVERED: *3/1/99 - 7/31/01* REFERENCE MARKERS / NODES:

REMARKS: *E. 177 th St + I-895 Offramp*

DATE: *8/16/04*

TIME OF DAY	# ACC	%	DIRECTION	# ACC	%	DIRECTION	# ACC	%
6 AM - 10 AM	8	18.6%	North	1	1.2%	Northeast	0	0.0%
10 AM - 4 PM	17	39.5%	South	16	18.8%	Northwest	0	0.0%
4 PM - 7 PM	5	11.6%	East	13	15.3%	Southeast	0	0.0%
7 PM - 12 AM	9	20.9%	West	55	64.7%	Southwest	0	0.0%
12 AM - 6 AM	4	9.3%				Unspecified	0	0.0%
Unspecified	0	0.0%						
<b>Total</b>	<b>43</b>		<b>Total</b>	<b>85</b>				

WEATHER	# ACC	%	ACCIDENT TYPE	# ACC	%	ACCIDENT TYPE	# ACC	%
Clear	31	72.1%	Rear End	19	44.2%	Pedestrian	0	0.0%
Cloudy	8	18.6%	Overtake	20	46.5%	Bicycle	0	0.0%
Rain	3	7.0%	Right Angle	0	0.0%	Parked Vehicle	0	0.0%
Snow	0	0.0%	Left Turn	0	0.0%	Backing	0	0.0%
Sleet/Hail/Freezing Rain	0	0.0%	Right Turn	0	0.0%	Run Off The Road	0	0.0%
Fog/Smog/Smoke	0	0.0%	Fixed Object	3	7.0%	Animal	0	0.0%
Unspecified	1	2.3%	Head On	0	0.0%	Other	0	0.0%
			Sideswipe	1	2.3%	Unspecified	0	0.0%
<b>Total</b>	<b>43</b>		<b>Total</b>	<b>43</b>				

SURFACE	# ACC	%	ACCIDENT SEVERITY	# ACC	%
Dry	37	86.0%	Fatal	0	0.0%
Wet	5	11.6%	Injury	11	25.6%
Mud/Slush	0	0.0%	Property Damage	32	74.4%
Snow/Ice	0	0.0%	Non-Reportable	0	0.0%
Unspecified	1	2.3%			
<b>Total</b>	<b>43</b>		<b>Total</b>	<b>43</b>	

TIME OF YEAR	# ACC	%	TYPE OF VEHICLE	# ACC	%
Winter (Dec-Feb)	8	18.6%	Passenger Cars	89	96.7%
Spring (Mar-May)	12	27.9%	Commercial Vehicles	3	3.3%
Summer (Jun-Aug)	14	32.6%			
Fall (Sep-Nov)	9	20.9%	<b>Total</b>	<b>92</b>	
<b>Total</b>	<b>43</b>				

DAY OF WEEK	# ACC	%	LIGHT CONDITION	# ACC	%
Sunday	8	18.6%	Daylight	31	72.1%
Monday	7	16.3%	Dawn/Dusk	4	9.3%
Tuesday	3	7.0%	Night	8	18.6%
Wednesday	6	14.0%	Unspecified	0	0.0%
Thursday	9	20.9%			
Friday	5	11.6%	<b>Total</b>	<b>43</b>	
Saturday	5	11.6%			
<b>Total</b>	<b>43</b>				

SUMMARY OF ACCIDENT SEVERITY BY YEAR:	1999	2000	2001
Fatal Accidents	0	0	0
Injury Accidents	5	4	2
Property Damage Accidents	9	15	8
Non-Reportable Accidents	0	0	0
<b>Total Accidents</b>	<b>14</b>	<b>19</b>	<b>10</b>

# ACCIDENT SUMMARY SHEET

ROUTE: *Bronx River Greenway*

LOCATION:

MUNICIPALITY: *BRONX*

COUNTY: *BRONX*

TIME PERIOD COVERED: *3/1/99 - 7/31/01* REFERENCE MARKERS / NODES: *-*

REMARKS: *E. Tremont Ave + Devoe Ave+ E.177 St.*

DATE: *8/16/04*

TIME OF DAY	# ACC	%	DIRECTION	# ACC	%	DIRECTION	# ACC	%
6 AM - 10 AM	12	20.3%	North	16	14.3%	Northeast	0	0.0%
10 AM - 4 PM	22	37.3%	South	16	14.3%	Northwest	0	0.0%
4 PM - 7 PM	14	23.7%	East	41	36.6%	Southeast	0	0.0%
7 PM - 12 AM	10	16.9%	West	39	34.8%	Southwest	0	0.0%
12 AM - 6 AM	1	1.7%				Unspecified	0	0.0%
Unspecified	0	0.0%						
<b>Total</b>	<b>59</b>		<b>Total</b>	<b>112</b>				

WEATHER	# ACC	%	ACCIDENT TYPE	# ACC	%	ACCIDENT TYPE	# ACC	%
Clear	45	76.3%	Rear End	21	35.6%	Pedestrian	2	3.4%
Cloudy	5	8.5%	Overtake	19	32.2%	Bicycle	1	1.7%
Rain	9	15.3%	Right Angle	2	3.4%	Parked Vehicle	0	0.0%
Snow	0	0.0%	Left Turn	6	10.2%	Backing	0	0.0%
Sleet/Hail/Freezing Rain	0	0.0%	Right Turn	3	5.1%	Run Off The Road	2	3.4%
Fog/Smog/Smoke	0	0.0%	Fixed Object	2	3.4%	Animal	0	0.0%
Unspecified	0	0.0%	Head On	0	0.0%	Other	0	0.0%
			Sideswipe	1	1.7%	Unspecified	0	0.0%
<b>Total</b>	<b>59</b>		<b>Total</b>	<b>59</b>				

SURFACE	# ACC	%
Dry	47	79.7%
Wet	12	20.3%
Mud/Slush	0	0.0%
Snow/Ice	0	0.0%
Unspecified	0	0.0%
<b>Total</b>	<b>59</b>	

ACCIDENT SEVERITY	# ACC	%
Fatal	0	0.0%
Injury	20	33.9%
Property Damage	39	66.1%
Non-Reportable	0	0.0%
<b>Total</b>	<b>59</b>	

TIME OF YEAR	# ACC	%
Winter (Dec-Feb)	14	23.7%
Spring (Mar-May)	15	25.4%
Summer (Jun-Aug)	16	27.1%
Fall (Sep-Nov)	14	23.7%
<b>Total</b>	<b>59</b>	

TYPE OF VEHICLE	# ACC	%
Passenger Cars	116	100.0%
Commercial Vehicles	0	0.0%
<b>Total</b>	<b>116</b>	

DAY OF WEEK	# ACC	%
Sunday	8	13.6%
Monday	8	13.6%
Tuesday	11	18.6%
Wednesday	11	18.6%
Thursday	3	5.1%
Friday	12	20.3%
Saturday	6	10.2%
<b>Total</b>	<b>59</b>	

LIGHT CONDITION	# ACC	%
Daylight	38	64.4%
Dawn/Dusk	11	18.6%
Night	10	16.9%
Unspecified	0	0.0%
<b>Total</b>	<b>59</b>	

**SUMMARY OF ACCIDENT SEVERITY BY YEAR:**

	1999	2000	2001
Fatal Accidents	0	0	0
Injury Accidents	8	10	2
Property Damage Accidents	11	23	5
Non-Reportable Accidents	0	0	0
<b>Total Accidents</b>	<b>19</b>	<b>33</b>	<b>7</b>

# ACCIDENT SUMMARY SHEET

ROUTE: *Bronx River Greenway*

LOCATION:

MUNICIPALITY: *BRONX*

COUNTY: *BRONX*

TIME PERIOD COVERED: *3/1/99 - 7/31/01* REFERENCE MARKERS / NODES: *-*

REMARKS: *E. Tremont Ave +Boston Rd+ W. Farm Rd* DATE: *8/16/04*

TIME OF DAY	# ACC	%	DIRECTION	# ACC	%	DIRECTION	# ACC	%
6 AM - 10 AM	6	21.4%	North	11	22.9%	Northeast	0	0.0%
10 AM - 4 PM	8	28.6%	South	10	20.8%	Northwest	0	0.0%
4 PM - 7 PM	7	25.0%	East	9	18.8%	Southeast	0	0.0%
7 PM - 12 AM	6	21.4%	West	18	37.5%	Southwest	0	0.0%
12 AM - 6 AM	1	3.6%				Unspecified	0	0.0%
Unspecified	0	0.0%						
<b>Total</b>	<b>28</b>		<b>Total</b>	<b>48</b>				

WEATHER	# ACC	%	ACCIDENT TYPE	# ACC	%	ACCIDENT TYPE	# ACC	%
Clear	16	57.1%	Rear End	9	32.1%	Pedestrian	8	28.6%
Cloudy	7	25.0%	Overtake	5	17.9%	Bicycle	0	0.0%
Rain	2	7.1%	Right Angle	0	0.0%	Parked Vehicle	0	0.0%
Snow	1	3.6%	Left Turn	2	7.1%	Backing	0	0.0%
Sleet/Hail/Freezing Rain	0	0.0%	Right Turn	0	0.0%	Run Off The Road	0	0.0%
Fog/Smog/Smoke	0	0.0%	Fixed Object	3	10.7%	Animal	0	0.0%
Unspecified	2	7.1%	Head On	0	0.0%	Other	0	0.0%
			Sideswipe	1	3.6%	Unspecified	0	0.0%
<b>Total</b>	<b>28</b>		<b>Total</b>	<b>28</b>				

SURFACE	# ACC	%	ACCIDENT SEVERITY	# ACC	%
Dry	21	75.0%	Fatal	0	0.0%
Wet	4	14.3%	Injury	14	50.0%
Mud/Slush	0	0.0%	Property Damage	14	50.0%
Snow/Ice	1	3.6%	Non-Reportable	0	0.0%
Unspecified	2	7.1%			
<b>Total</b>	<b>28</b>		<b>Total</b>	<b>28</b>	

TIME OF YEAR	# ACC	%	TYPE OF VEHICLE	# ACC	%
Winter (Dec-Feb)	7	25.0%	Passenger Cars	47	100.0%
Spring (Mar-May)	7	25.0%	Commercial Vehicles	0	0.0%
Summer (Jun-Aug)	11	39.3%			
Fall (Sep-Nov)	3	10.7%			
<b>Total</b>	<b>28</b>		<b>Total</b>	<b>47</b>	

DAY OF WEEK	# ACC	%	LIGHT CONDITION	# ACC	%
Sunday	6	21.4%	Daylight	20	71.4%
Monday	2	7.1%	Dawn/Dusk	0	0.0%
Tuesday	4	14.3%	Night	6	21.4%
Wednesday	4	14.3%	Unspecified	2	7.1%
Thursday	4	14.3%			
Friday	4	14.3%			
Saturday	4	14.3%			
<b>Total</b>	<b>28</b>		<b>Total</b>	<b>28</b>	

SUMMARY OF ACCIDENT SEVERITY BY YEAR:	1999	2000	2001
Fatal Accidents	0	0	0
Injury Accidents	6	5	3
Property Damage Accidents	4	6	4
Non-Reportable Accidents	0	0	0
<b>Total Accidents</b>	<b>10</b>	<b>11</b>	<b>7</b>

PERIOD STUDIED:		ROUTE NUMBER/STREET NAME: Greenway New Data Set		CASE No.							
FROM: 3/1/99		LOCATION: I-895 Offramp + E. 177 th St + Devoe Ave		FILE: greenway							
TO: 7/31/01		MUNICIPALITY: BRONX COUNTY: BRONX		BY:							
29 MONTHS		REFERENCE MARKERS / NODES:		DATE: 8/16/04							
No.	DATE	TIME	# VEHICLES	S E V E R I T Y	L I G H T C O N D	R O A D C H A R E	W E A T H E R	CONTRIB. FACTORS	ACC. TYPE	ACCIDENT DESCRIPTION	KEY #
37	6/1/00	15:50	4	PDO	1 1 1	1 1 1	1 1 1	47	FixO	V1 TRUCK LOST CONTROL AND HIT PAKRED CARS.	3
52	8/3/00	1:00	1	INJ	1 1 1	1 1 2	2		FixO	V1 HIT GUIDE RAIL WHEN AVOID UNKOWN VEH ENTERING THE INT.	3
70	4/24/00	5:30	1	PDO	2 1 2	3			FixO	UNKOWN VEH 1 KNOCK DOWN FENCE.	3
1	12/6/00	20:25	2	PDO	4 1 1	2			Ovtk	V1 AND V2 E177 DEVOE ST. V2 LEFT LN OVERTAKE AND MAKE R/T	3
2	3/21/01	8:50	2	PDO	1 1 1	2			Ovtk	V1 AND V2 E177 ST W/B. V2 OVERTAKE V1 FROM LEFT LN.	3
4	4/8/01	1:08	2	PDO	4 1 1	2			Ovtk		3
9	2/10/01	15:35	2	PDO	1 1 1	1			Ovtk	V1 JUST AFTER RIGHT TURN FROM E. TREMONT. V2 REAR END V1	3
19	2/10/00	16:30	2	PDO	1 1 2	3			Ovtk	V1 E.177 ST W/B THRU. V2 R/T ONLY LN MAKE IMPROPER LN CHANGE.	3
32	5/15/00	12:56	2	PDO	1 3 1	1			Ovtk	V1 AND V2 W/B ON E 177 ST.	3
33	5/15/00	14:56	2	PDO	1 1 1	1			Ovtk	V1 AND V2 DEVOE AVE S/B.	3
36	6/1/00	8:42	2	PDO	1 1 1	1	40 7 7		Ovtk	V1 AND V2 S/B DEVOE AVE B4 E177 ST.	3
39	6/7/00	8:55	2	PDO	1 2 1	1	60 80 60 80		Ovtk	V1 W/B E. TREMONT AVE RIGHT LN MAKE RIGHT TURN.	3
64	6/18/00	14:10	2	PDO	4 2 2	2			Ovtk	V1 AND V2 E 177 ST W/B.	3
84	12/20/99	15:05	4	INJ	1 2 1	1	9 42		Ovtk	ALL VEH W/B E. 177 ST.	3
93	12/2/99	8:15	2	PDO	1 2 1	1	4 9		Ovtk	V1 W/B 177 ST. V2 CHANGE LANE IMPROPERLY.	3
104	9/19/99	9:20	2	PDO	1 1 1	1			Ovtk	V1 AND V2 S/B DEVOE AVE NEAR ENTRANCE TO SHERIDAN EXPRESSWAY	3
106	7/1/01	4:35	2	PDO	1 1 1	1			Ovtk	V1 S/B DEVOE AVE MAKE LT. V2 OUTSIDE LN MAKE ILLEGAL U-TURN,	3
107	6/26/01	15:25	2	PDO	1 1 1	1			Ovtk	V2 S/B DEVOE AVE MAKE L/T. V1 SAME DIRECTION OVERTAKE V1.	3
108	7/19/01	21:05	2	INJ	4 1 1	1			Ovtk	V1 AND V2 W/B E. 177 ST. V1 OVERTAKE V2(TRUCK).	3
124	4/10/99	19:40	2	PDO	3 2 1	1			Ovtk	V1 AND V2 W/B E. 177 ST. OVERTAKE WHEN BOTH MAKE RIGHT TURN.	3
127	5/28/99	15:00	2	PDO	1 2 1	1	13		Ovtk	V1 AND V2 EXIT EXPRESSWAY.	3
128	5/31/99	16:30	2	PDO	1 1 1	1	40		Ovtk	V1 AND V2 S/B DEVOE AVE. BOTH VEH MAKE RIGHT TURN WHEN OVERTAKE	3





PERIOD STUDIED:		ROUTE NUMBER/STREET NAME: Greenway New Data Set		CASE No.							
FROM:	TO:	LOCATION:	MUNICIPALITY:	FILE:	greenway						
3/1/99	7/31/01	E. Tremont Ave (and) Devoe Ave + E. Tremont Ave	BRONX	BY:							
29 MONTHS		REFERENCE MARKERS / NODES:	BRONX	DATE:	8/16/04						
No.	DATE	TIME	# VEHICLES	S E V E R I T Y	L I G H T C O N D	R O A D C H A R E	W E A T H E R	CONTRIB. FACTORS	ACC. TYPE	ACCIDENT DESCRIPTION	KEY #
72	5/1/00	14:45	1	INJ	1	1	1		Bike	V1 E/B E TREMONT MAKE L/T AND HIT BICYCLIST CROSSING DEVOE AVE.	4
30	4/18/00	12:00	2	PDO	1	1	1		FixO	V1 PARKED ON STREET. V2 HIT V1.	4
62	11/4/00	11:00	1	PDO	1	2	1		FixO	V1 TRY TO AVOID ACCIDENT AND HIT CURB.	4
50	11/3/00	12:45	2	INJ	1	1	1		Ltrn	V1 E/B E. TREMONT AVE MAKE L/T. V2 W/B THRU.	4
77	1/29/00	7:00	3	INJ	2	1	2	66 40 66	Ltrn	V1 E/B E TREMONT AVE MAKE L/T. V2 W/B E. TREMONT THRU.	4
82	9/10/99	15:00	2	PDO	1	1	2		Ltrn	V1 W/B E. TREMONT AVE MAKE L/T. V2 E/B E. TREMONT AVE.	4
98	11/9/99	16:05	2	INJ	1	1	1		Ltrn	V1 W/B E. TREMONT AVE MAKE L/T, V2 E/B TREMONT AVE THRU.	4
99	11/19/99	8:30	2	INJ	1	1	1		Ltrn	V1E/B E. TREMONT AVE MAKE L/T V2 W/B E. TREMONT AVE THRU.	4
119	8/4/99	13:20	2	INJ	1	1	1	7 18	Ltrn	V1 E/B E. TREMONT AVE MAKE L/T. V2 W/E B E. TREMONT GO STRAIGHT.	4
15	1/20/01	16:00	2	PDO	1	1	1	9 18	Ovtk	V1 V2 N/B DEVOE AVE. OVERTAKE WHEN L/T.	4
21	8/9/00	14:15	2	PDO	1	1	1		Ovtk	V1 AND V2 E/B E TREMONT AVE. V2 RUN INTO V1.	4
22	9/18/00	10:12	2	PDO	1	1	1	4 4	Ovtk	V1 AND V2 W/B E. TREMONT AVE. V2 MAKE L/T FROM MIDDLE LN	4
31	5/10/00	17:25	2	PDO	3	1	2		Ovtk	V1 E/B E. TREMONT AVE MAKE R/T. V2 SAME	4
38	5/29/00	17:09	2	PDO	1	1	1	7	Ovtk	V1 EB E. TREMONT AVE LEFT LANE OVERTAKE V2 RIGHT LN BUS	4
43	2/6/00	19:11	2	PDO	3	1	1		Ovtk	V1 AND V2 S/B DEVOE AVE AFTER EXITING CAR WASH.	4
45	2/22/00	9:00	2	PDO	1	1	1		Ovtk	V1 AND V2 W/B E. TREMONT AVE READ END.	4
48	5/15/00	9:40	2	PDO	1	1	1		Ovtk	V1 W/B E TREMONT AVE. V2 CHANGE LN IMPROPERLY.	4
49	3/20/00	16:32	2	PDO	1	1	1		Ovtk	V1 AND V2 N/B DEVOE AVE BEFORE E. TREMONT.	4
51	12/28/00	18:50	2	PDO	4	1	1	60 60	Ovtk	V1 STOPP FOR RED LIGHT. V2 PASS HIM FROM THE RIGHT.	4
57	11/12/00	18:20	2	INJ	4	1	1	19 7	Ovtk		4
59	12/10/00	17:00	2	PDO	4	1	2	18 4 4	Ovtk	V2 W/B E. TREMONT LEFT LN THRU. V1 RIGHT LN SAME DIR. MAKE L/T	4
65	6/13/00	20:30	2	PDO	3	1	1		Ovtk	V1 AND V2 W/B E. TREMONT AVE.	4

No.	DATE	TIME	PERIOD STUDIED:		# VEHICLES	S E V E R I T Y	L I G H T C O N D	R O A D C H A C R E	W E A T H E R	ROUTE NUMBER/STREET NAME: Greenway New Data Set		CASE No.	
			FROM:	TO:						LOCATION: E. 177th St + E. Tremont Ave (and) Devoe Ave + E. Tremont Ave	MUNICIPALITY: BRONX	FILE:	BY:
					MUNICIPALITY: BRONX				COUNTY: BRONX		8/16/04		
					REFERENCE MARKERS / NODES:								
			CONTRIB. FACTORS	ACC. TYPE	ACCIDENT DESCRIPTION					KEY #			
75	1/9/00	20:05	2	INJ	5	1	2	3	13	Ovtk	V1 AND V2 W/V E. TREMONT AVE.	4	
83	8/30/99	8:30	2	PDO	1	1	1	1		Ovtk	V1 RIGHT LN E/B E. TREMONT AVE. V2 LEFT CUT OFF AND MAKE L/T	4	
101	9/22/99	8:20	2	PDO	1	1	2	2	7	Ovtk	V1 AND V2 W/B E. TREMONT AVE. V2 CHANGE LN IMPROPERLY.	4	
115	6/25/99	9:25	2	PDO	1	1	1	1		Ovtk	V1 AND V2 E/B THRU E. TREMONT AVE 50 FT EAST OF DEVOE AVE.	4	
117	6/15/99	12:30	2	PDO	1	1	1	1	40	Ovtk	V1+ V2 E/B E. TREMONT AVE. V2 CUT INFRONT OF V1.	4	
126	5/22/99	16:40	2	INJ	1	1	1	2		Ovtk	V1 LEFT LN E/B E. TREMONT AVE, V2 RT LN E/B TREMONT MKE U-TURN	4	
100	11/24/99	12:00	1	INJ	1	1	1	1	40	Ped	V1 S/B DEVOE AVE NEAR WYATT ST. PED CROSS ST E/B.	4	
123	5/5/99	19:50	1	INJ	3	1	1	1	4 7	Ped	V1 E/B WYATT ST HIT PED AND FLEE THE SCENE.	4	
74	6/7/00	20:15	2	INJ	2	1	1	1		Rang	V1 E. TREMONT AVE E/B THRU. V2 EXIT MAC PARKING LOT.	4	
87	12/24/99	13:33	2	INJ	3	1	1	1		Rang	V1 E/B E. TREMONT AVE. V2 EXIT CAR WASH DRIVEWAY.	4	
6	6/9/01	10:45	2	INJ	1	1	1	1	40	Rend	V1 AND V2 E. TREMONT AVE W/B BEFORE DEVOE AVE.	4	
14	1/31/01	9:30	2	PDO	1	1	1	1		Rend	V1 AND V2 N/B DEVOE AVE.	4	
18	2/18/01	12:20	2	PDO	1	1	1	1		Rend	V1 AND V2 E/B E TREMONT AVE.	4	
24	9/21/00	19:07	3	PDO	3	1	1	1		Rend	V1 STOP AT LIGHT. V2 HIT V2 FROM BEHIND.	4	
27	8/29/00	18:00	2	PDO	1	1	1	1	40	Rend	V1 STOP AT LIGHT. V2 HIT V1 FROM BEHIND	4	
29	11/5/00	16:30	2	PDO	1	1	1	1	4	Rend	V1 AND V2 S/B DEVOE AVE.	4	
34	4/23/00	15:17	2	PDO	1	1	2	3		Rend	V1 E/B E. TREMONT AVE MAKE L/T. V2 HIT V1 FROM BEHIND	4	
40	10/4/00	17:00	2	INJ	1	1	1	1	4	Rend	V1 & V2 E. TREMONT AVE W/B	4	
41	3/29/00	19:30	2	PDO	3	1	1	1	40 2	Rend	V1 W/B E. TREMONT AVE STOPPED. V2 REAR END V1	4	
47	3/13/00	10:10	2	PDO	1	1	1	1		Rend	V1 DOUBLE PARKING PULL OUT. V2 BEHIND REAR END V1.	4	
54	8/22/00	8:00	2	PDO	1	1	1	1		Rend	V1 E/B E. TREMONT AVE IS ABOUT TO RIGHT TURN ; V3 REAR END V1	4	
56	1/2/01	10:00	2	INJ	1	1	2	3		Rend	V1 STOP IN TRAFFIC TO YEILD ONCOMING TRAFFIC. V2 REAR END V1.	4	



PERIOD STUDIED:		# VEHICLES	S E V E R I T Y	L I G H T C O N D	R O A D C H A R A C T E R	W E A T H E R	ROUTE NUMBER/STREET NAME: Greenway New Data Set		CASE No.			
FROM:	TO:						29 MONTHS	3/1/99	7/31/01	LOCATION: E. Tremont Ave + Boston Rd + W. Farm Rd	MUNICIPALITY: BRONX	COUNTY: BRONX
No.	DATE	TIME	REFERENCE MARKERS / NODES:				CONTRIB. FACTORS	ACC. TYPE	ACCIDENT DESCRIPTION	KEY #		
67	7/15/00	20:15	1	PDO	4	2	1	2	60	FixO	V1 N/B ON BOSTON ROAD HIT TRAIN SUPPORT BEAM	5
103	8/15/99	8:00	1	INJ						FixO	V1 BOSTON RD N/B LOST CONTROL AND HIT PILLOW.	5
116	6/20/99	14:30	2	INJ	1	1	1	1	40	FixO	V1 W/B E. TREMONT AVE HIT PARKED VEH WHEN AVOID ACCIDENT VEH.	5
63	6/15/00	10:45	2	PDO	1	4	1	2		Ltrn	V1 BOSTON RD S/B MAKE L/T TO E. TREMONT. V2 W. FARM RD THRU.	5
112	7/31/01	17:30	2	PDO	1	1	1	1		Ltrn	V1 W/B E. TREMONT AVE MAKE L/T. V2 E/B E. TREMONT AVE THRU.	5
3	4/16/01	20:10	2	PDO	4	1	1	1		Ovtk	V1 AND V2 E TREMONT AVE E/B. V2 OVERTAKE V1 FROM LEFT.	5
26	9/29/00	15:30	2	PDO	1	1	1	1	4 4 69	Ovtk	V1 OVERTAKE V2 WHILE CHANGING TO RT LN.	5
35	4/2/00	17:30	2	PDO	1	2	1	2		Ovtk	V1 PARKED. V2 SIDESWIPE V1.	5
69	7/25/00	9:10	2	INJ	1	1	1	2		Ovtk	V1 AND V2 N/B WEST FARM RD.	5
73	5/5/00	12:20	2	INJ						Ovtk	V1 AND V2 W/B E. TREMONT AVE.	5
11	4/3/01	22:20	2	PDO	1	1	1	1	14	Ped	V1 BOSTON RD S/B AFTER E. TREMONT. PED CROSS BOSTON RD	5
12	1/14/01	20:00	1	INJ	4	1	1	2		Ped	V1 T FROM E TREMONT SB TO BOSTON S/B HIT PED.	5
79	2/2/00	16:30	1	INJ	1	1	1	1		Ped	V1 S/B BOSTON RD HIT PED CROSSING INTERSECTION.	5
80	2/11/00	9:50	1	INJ	1	3	2	2		Ped		5
90	12/1/99	8:20	1	PDO	1	1	1	1	40	Ped	V1 W/B E. TREMONT AVE. PED S/B CROSS E. TREMONT FOR BUS.	5
95	3/3/99	20:30	1	INJ	4	1	2	3		Ped	V1 S/B BOSTON RD TO W. FARM RD. PED CROSS W. FARM TO BUS STATION	5
110	4/13/99	17:35	1	INJ	1	2	1	2		Ped	V1 S/B BOSTON RD. PED CROSS STREET E/B	5
111	7/23/01	11:30	1	INJ	1	1	1	1	40 69	Ped	V1 N/B BOSTON RD. PED E/B CROSS STREET.	5
7	6/2/01	19:00	2	PDO	1	1	2	1	5	Rend	V1 AND V2 E. TREMONT AVE E/B BEFORE DEVOE AVE.	5
13	1/20/01	12:20	2	INJ	1	1	2	3	2 4	Rend	V1 V2 E TREMONT E/B. V1 HIT V2 FROM BEHIND	5
46	2/26/00	16:15	2	PDO	1	1	1	1	4 9	Rend	V1 AND V2 E. TREMONT AVE W/B.	5
53	10/11/00	8:25	2	PDO	1	4	1	1	40 80 40 80	Rend	V1 S/B W. FARM RD STOP SHARPLY FOR CHILD CROSS. V2 READ REND V1	5

PERIOD STUDIED:		ROUTE NUMBER/STREET NAME: Greenway New Data Set										CASE No.		
FROM: 3/1/99		LOCATION: E. Tremont Ave + Boston Rd + W. Farm Rd										FILE: greenway		
TO: 7/31/01		MUNICIPALITY: BRONX COUNTY: BRONX										BY:		
29 MONTHS		REFERENCE MARKERS / NODES: -										DATE: 8/16/04		
No.	DATE	TIME	# VEHICLES	SEVERITY	LIGHT	ROAD	SURFACE	WEATHER	CONTRIB. FACTORS	ACC. TYPE	ACCIDENT DESCRIPTION	KEY #		
55	8/10/00	13:27	2	INJ	1	1	1	1		Rend	V1 STOP AT TRAFFIC LIGHT. V2 REAR END V1.	5		
89	10/8/99	18:56	2	PDO	4	1	1	1		Rend	V1 AND V2 TRAVEL W/B E. TREMONT AVE WHEN REAR END.	5		
94	12/2/99	7:30	2	INJ	1	1	1	1	40 17	Rend	V1 W/B E. TREMONT AVE STOP AT RED LIGHT; V2 REAR END V1	5		
114	8/1/99	18:25	2	INJ	1	2	1	1		Rend	V1 AND V2 W/B E. TREMONT AVE. V1 HIT V2 PUSHING V2 TO HIT PED	5		
120	8/5/99	15:15	2	PDO	1	1	1	1	6 9	Rend	V1 AND V2 N/B W. FARM RD REAR END WHEN CROSS INTERSECTION	5		
86	3/7/99	4:20	2	PDO	4	5	4	4	66 66	Side	V1 BOSTON ROAD S/B, V2 BOSTON RD N/B.	5		

FED ROAD REG. NO.	STATE	CONTRACT NO.	SHEET NO.	TOTAL SHEETS
1	N.Y.			
BRONX RIVER GREENWAY				
BRONX COUNTY				
P.I.N. X027.05			B.I.N.	

DESIGN SUPERVISOR \_\_\_\_\_ CHECKED BY \_\_\_\_\_ DESIGNED BY \_\_\_\_\_ CHECKED BY \_\_\_\_\_ DRAFTED BY \_\_\_\_\_ CHECKED BY \_\_\_\_\_

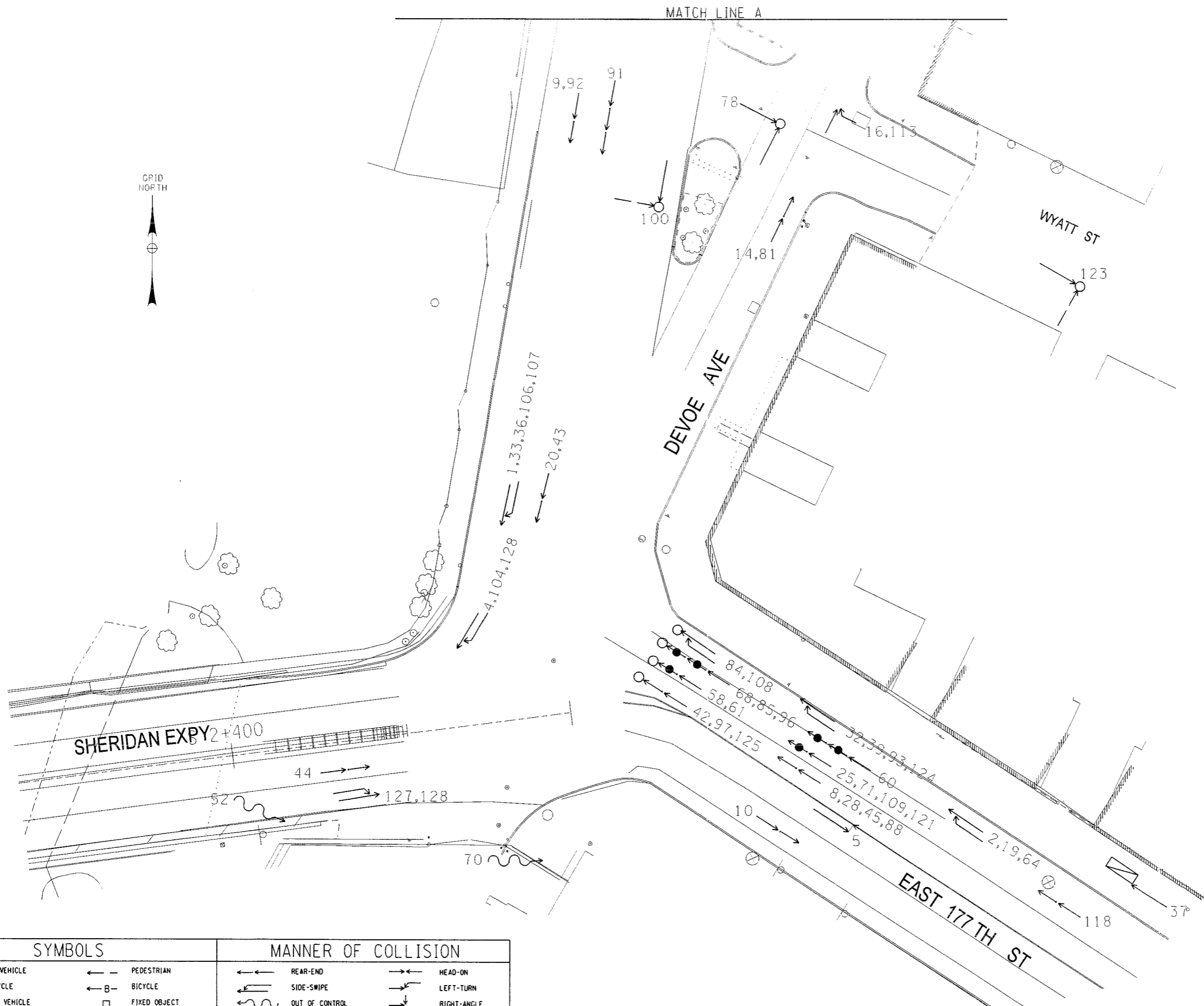

FILE NAME : DGN\$SYTIME0123456  
 DATE/TIME : DGN\$SYTIME0123456  
 USER : DGN\$USER

SYMBOLS		MANNER OF COLLISION	
→	MOVING VEHICLE	←→	REAR-END
←M	MOTORCYCLE	→←	HEAD-ON
←→	BACKING VEHICLE	→←	SIDE-SWIPE
●	STOPPED VEHICLE	→←	OUT OF CONTROL
▭	PARKED VEHICLE	→←	SKIDDING
←	PEDESTRIAN	→←	OVERTURNED
←B	BICYCLE	→←	LEFT-TURN
□	FIXED OBJECT	→←	RIGHT-ANGLE
○	PERSONAL INJURY		
●	FATAL INJURY		

ALL DIMENSIONS ARE IN m UNLESS OTHERWISE NOTED  
AS BUILT REVISIONS

\_\_\_\_\_  
SIGNATURE DATE

ACCIDENT DIAGRAM  
( 1 OF 3 )

STATE OF NEW YORK  
DEPARTMENT OF TRANSPORTATION

DOCUMENT NAME ACCIDENT_CUTSHEET_1.DGN	REGION 11	DATE FEBRUARY 2005	DRAWING NO.
------------------------------------------	--------------	-----------------------	-------------

FED ROAD REG. NO.	STATE	CONTRACT NO.	SHEET NO.	TOTAL SHEETS
1	N.Y.			
BRONX RIVER GREENWAY				
BRONX COUNTY				
P.I.N. X027.05			B.I.N.	

DESIGN SUPERVISOR \_\_\_\_\_ JOB MANAGER \_\_\_\_\_ DESIGNED BY \_\_\_\_\_ CHECKED BY \_\_\_\_\_  
 ESTIMATED BY \_\_\_\_\_ DRAFTED BY \_\_\_\_\_ CHECKED BY \_\_\_\_\_

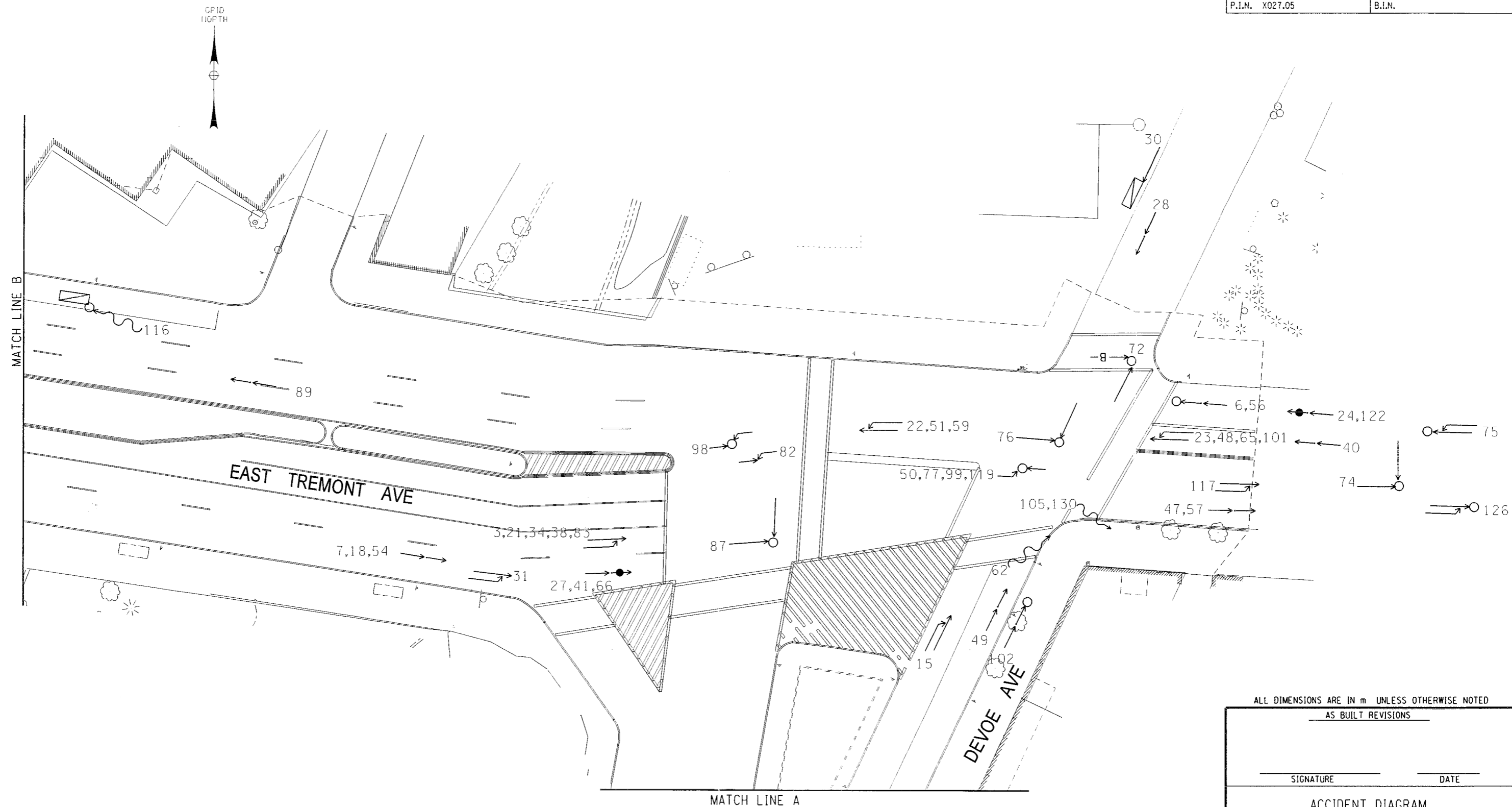

ALL DIMENSIONS ARE IN m UNLESS OTHERWISE NOTED  
AS BUILT REVISIONS

\_\_\_\_\_  
SIGNATURE DATE

ACCIDENT DIAGRAM  
(2 OF 3)

STATE OF NEW YORK  
DEPARTMENT OF TRANSPORTATION

DOCUMENT NAME ACCIDENT_CUTSHEET_2.DGN	REGION 11	DATE FEBRUARY 2005	DRAWING NO.
------------------------------------------	--------------	-----------------------	-------------

SYMBOLS		MANNER OF COLLISION	
← MOVING VEHICLE	← PEDESTRIAN	← REAR-END	→ HEAD-ON
← M MOTORCYCLE	← B BICYCLE	← SIDE-SWIPE	← LEFT-TURN
← B BACKING VEHICLE	□ FIXED OBJECT	← OUT OF CONTROL	← RIGHT-ANGLE
● STOPPED VEHICLE	○ PERSONAL INJURY	← SKIDDING	
▭ PARKED VEHICLE	● FATAL INJURY	← OVERTURNED	

FILE NAME = DGN\$SYTIME0123456  
 DATE/TIME = DGN\$USER\$NAME



FED ROAD REG. NO.	STATE	CONTRACT NO.	SHEET NO.	TOTAL SHEETS
1	N.Y.			
BRONX RIVER GREENWAY				
BRONX COUNTY				
P.I.N. X027.05			B.I.N.	

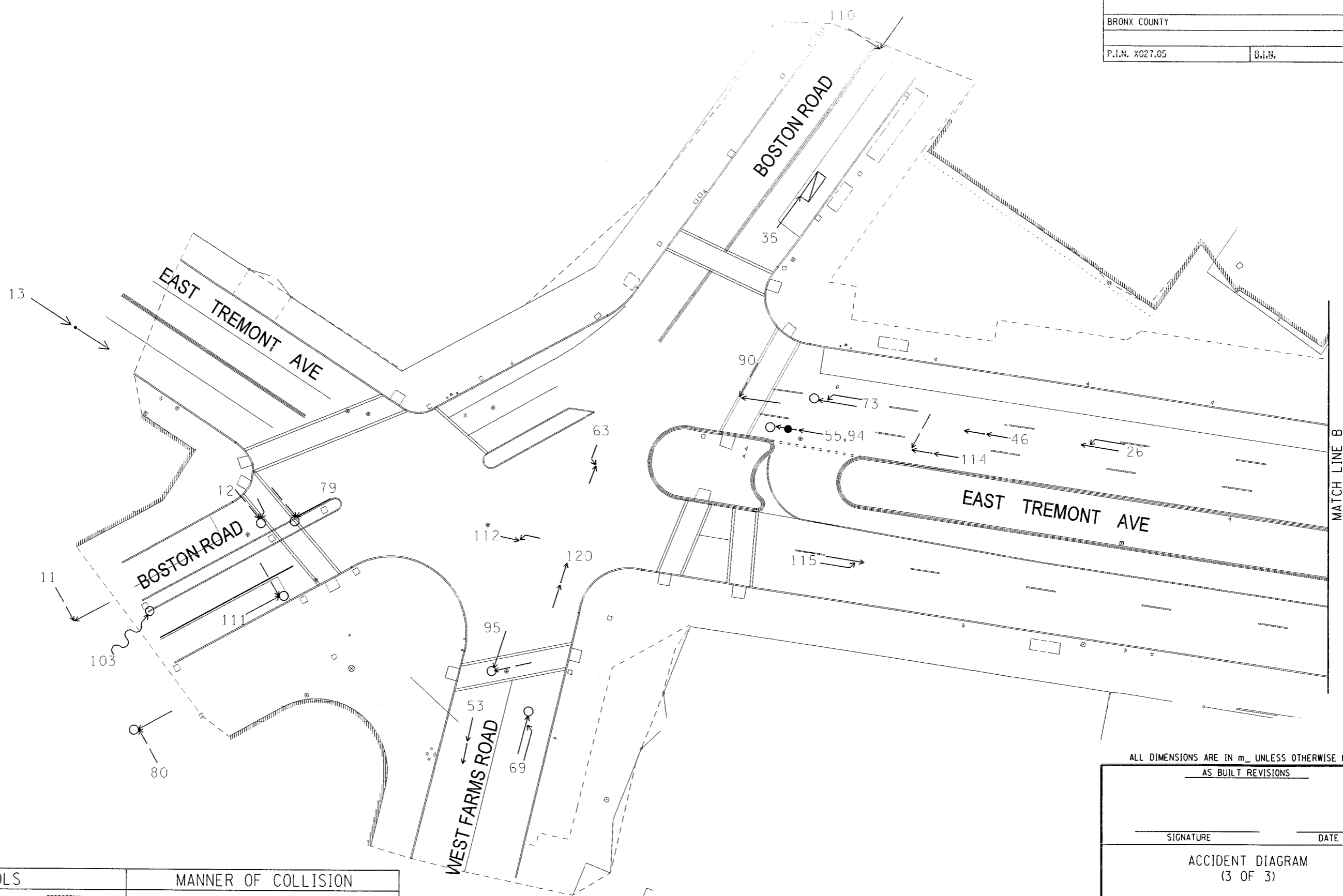
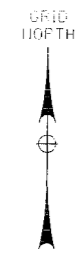

FILE NAME = DGN\SYTIME0123456  
 DATE/TIME = DGN\SYTIME0123456  
 USER = DGN\USERNAME  
 DESIGN SUPERVISOR  
 JOB MANAGER  
 DESIGNED BY  
 CHECKED BY  
 ESTIMATED BY  
 DRAFTED BY  
 CHECKED BY

ALL DIMENSIONS ARE IN m\_ UNLESS OTHERWISE NOTED  
AS BUILT REVISIONS

SIGNATURE \_\_\_\_\_ DATE \_\_\_\_\_

ACCIDENT DIAGRAM  
(3 OF 3)

STATE OF NEW YORK  
DEPARTMENT OF TRANSPORTATION

DOCUMENT NAME ACCIDENT_CUTSHEET.3.DGN	REGION 11	DATE FEBRUARY 2005	DRAWING NO.
------------------------------------------	--------------	-----------------------	-------------

**SYMBOLS**

←	MOVING VEHICLE	←	PEDESTRIAN
← M	MOTORCYCLE	← B	BICYCLE
←←	BACKING VEHICLE	□	FIXED OBJECT
●	STOPPED VEHICLE	○	PERSONAL INJURY
▭	PARKED VEHICLE	●	FATAL INJURY

**MANNER OF COLLISION**

←←	REAR-END	←→	HEAD-ON
←→	SIDE-SWIPE	←↘	LEFT-TURN
←~	OUT OF CONTROL	↘→	RIGHT-ANGLE
←~	SKIDDING		
←~	OVERTURNED		

FILE NAME = DGN\SYTIME0123456  
DATE/TIME = DGN\SYTIME0123456  
USER = DGN\USERNAME